



Professional 24 Inch Stainless Steel Surface Cleaner AW-7020-8006



Mi-T-M Corporation
8650 Enterprise Drive Peosta, IA 52068
Ph: 800-553-9053 - Fax: 563-556-1235

SPECIFICATIONS

Model	AW-7020-8006
Operating Pressure	1,000 to 4,000 PSI
Maximum Flow	4.0 GPM
Maximum Temp.	180°F
Nozzles (2 per unit)	25025
Weight	34 lbs
Dimensions	70" x 26.5" x 26.5"

⚠ WARNING

This product contains one or more chemicals known to the State of California to cause cancer and birth defects or other reproductive harm.

⚠ WARNING

Warning: This product contains lead, a chemical known to the State of California to cause birth defects or other reproductive harm.
Wash your hands after handling this product.

HAZARD	POTENTIAL CONSEQUENCE	PREVENTION
RISK OF BODILY INJURY	Serious injury or death could occur.	ALWAYS read, understand, and follow operation instructions. ALWAYS wear protective eye wear. ALWAYS keep clear of rotating nozzles. NEVER lock trigger gun open with any device.
RISK OF EQUIPMENT DAMAGE	Risk of major repair.	Drain water in cold weather to avoid freezing. Use only genuine Mi-T-M replacement parts for necessary repairs. Tampering with any part of this machine will void all warranties.

OPERATION:

Read, understand, and follow ALL safety guidelines and operation instructions prior to use.

1. Connect to pressure washer.
2. Turn water on and open valve. Open trigger gun for flow of water through nozzles. Nozzles must have flowing spray. If not, remove tips and clean; reassemble, making sure that groove of nozzle is parallel to spray bar. Use Teflon tape when installing nozzles.
3. Start pressure washer. The Rotary Surface Cleaner is ready for operation.
4. Walk slowly behind the Rotary Surface Cleaner cleaning as you go. If striping occurs, slow down your pace.
5. Check "weep holes" on bottom of swivel periodically. Water will seep slowly; if water shoots out, stop and replace seals. Swivel assembly can be rebuilt.
6. For maximum effectiveness keep spray tips clean. If the machine vibrates, stop and clean spray tips.

DO NOT ALLOW MACHINE TO REMAIN STATIONARY ON SOFT SURFACES, SUCH AS WOOD.

CAUTION: Striking any raised obstacle during operation will damage machine. If contact does occur and results in vibration when operating machine, STOP and replace spray bar. Continued operation could result in serious injury or damage to machine.



!SAVE THESE INSTRUCTIONS!

SET UP PROCEDURES



We recommend that you first fit the lower portion of the handle into the mounting brackets on the cover and secure with the bolts or the pins & clips.



Next, tighten the "fixed" hose end into the gun mounted onto the upper portion of the handle. Use teflon tape on the hose ends and tighten with a wrench until snug. Do not overtighten.

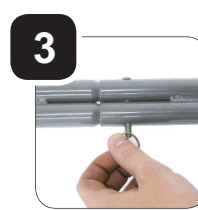

Once this is complete, join the two sections of the handle together and secure with the bolt or the pin & clip.



Next, tighten the swivel end of the hose with a wrench into the top of the rotary head until snug.



Turn the cover over and check to ensure that the nozzle tips are securely tightened and the spray pattern is in line with the rotary arm.



The factory presets the height of your rotary head from the ground based on peak performance. If you choose to lower or raise the height of the head, loosen the tension bolt in the collar.

** Note that lowering the head too far may result in the rotary arm hitting the surface and damaging it.

TROUBLE SHOOTING

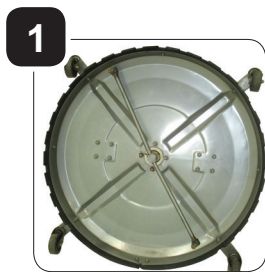

Rotary Arm doesn't spin:

- Remove, inspect and clean nozzles. Replace if damaged
- Ensure there is no water leaking excessively from the weep holes on the rotary head (water will normally seep out of these holes).



Leaves striping:

- Ensure nozzles aren't damaged or plugged.
- Ensure rotary arms are straight.
- Ensure nozzle groove is in alignment with arm.

PARTS LIST

AW-7020-8006

Ref. #	Description	Part #	Qty.
1	Ball Valve Kit	50-0210	1
2	Spray Gun	16-0465	1
3	Hose, 62" x 3/8"	15-0326	1
4	Handle, Lower	7-0244	1
5	Rotary Head*	33-0535	1
6	Collar	33-0534	1
7	Nylon Brush	33-0551	1
8	Caster	14-0135	4
9	Caster Bracket	13-0228	4

Ref. #	Description	Part #	Qty.
10	Cover	33-0552	1
11	Mounting Blocks	56-0072	2
12	Pin and Ring Set	43-0140	1
13	Handle, Upper	7-0243	1
14	Hand Grip	7-0237	1
15	Rotary Arm	33-0560	1
16	Nozzle, 25 Deg. 025	18-0299	2
*	Head Rebuild Kit	70-0598	1

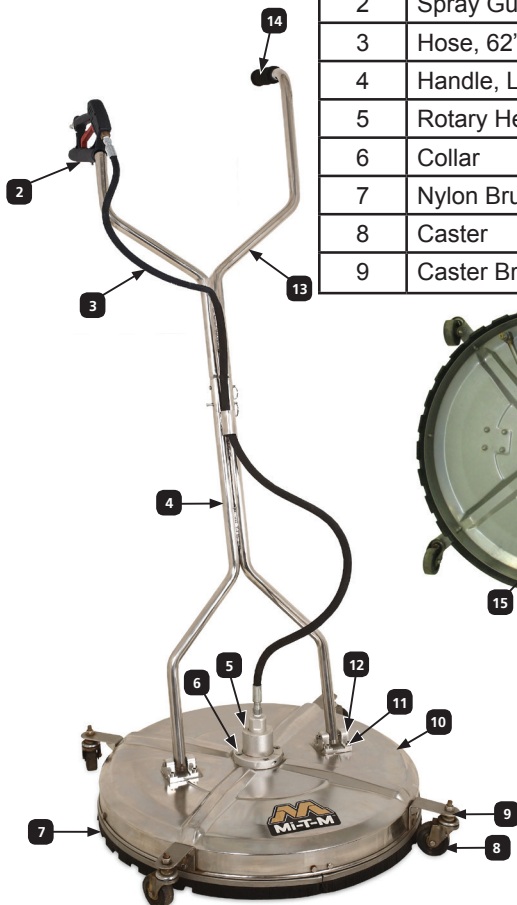

WHIRL-A-WAY ROTARY HEAD BREAKDOWN

Hose connection inlet

Stainless steel spring
 Viton O-Ring (25-0677)
 Stainless steel sleeve
 Stainless steel inlet valve with Carbide seat (22-0488 includes o-ring)
 Viton O-Ring (25-0678)
 Viton O-Ring (25-0679)
 Stainless steel bearings
 Aluminum housing
 Stainless steel rotating shaft

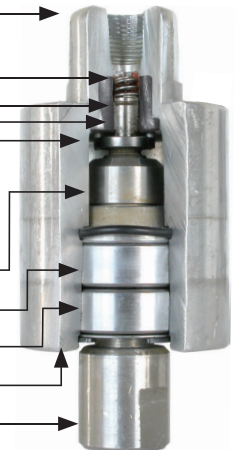

WARRANTY

The rotary head has a six-month warranty from the date of purchase. Should you encounter problems with the rotary head within that time period, simply return the defective part for warranty to the place of purchase. There is no warranty on the nylon brush ring. All other components of the surface cleaning system have a 90-day warranty against manufacturer's defects only.